

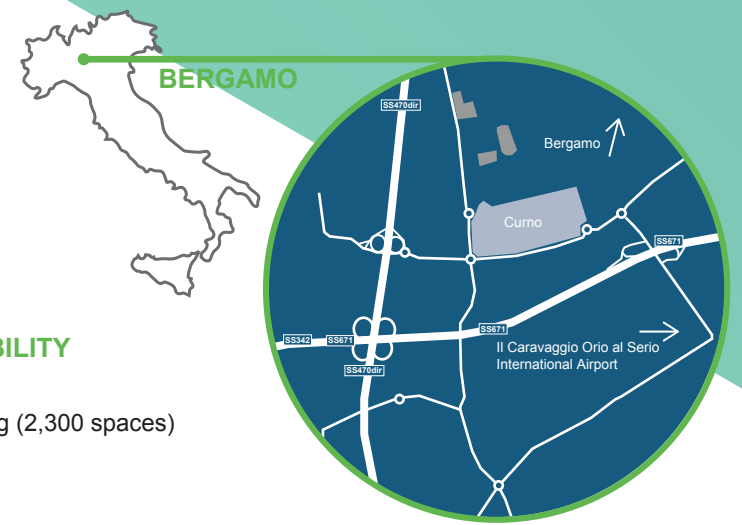

ESG & AWARDS  
**BREEM**®

**BERGAMO – OPENED 1991**  
*Refurbished in 2004*



Curno is well established in a wealthy catchment area west of Bergamo and has recently been extended with the development of a new themed dining hall that provides 17 food and beverage outlets.

**ACCESSIBILITY**  
 Parking (2,300 spaces)



**SERVICES**

- Click & Collect
- Loyalty Card
- Electric Car Charging
- Digital Signage/Advertising



TOP BRANDS

- 
- 
- 
- 
- 
- 
- 

**36,567**  
Gross lettable area

**14,787** **18,371**  
GLA Hyper GLA Gallery

**88**  
Number of stores

**6** **21**  
Medium units Restaurants

**481,000**  
Catchment

**6.1 million**  
Number of visitors\*

\* Based on 2019 numbers

# LEASING



**Carla Anderlini**  
M. 00 39 348 301 6523  
carla.anderlini@ecpnv.com

**Marco Parrello**  
M. 00 39 345 054 6896  
marco.parrello@ecpnv.com

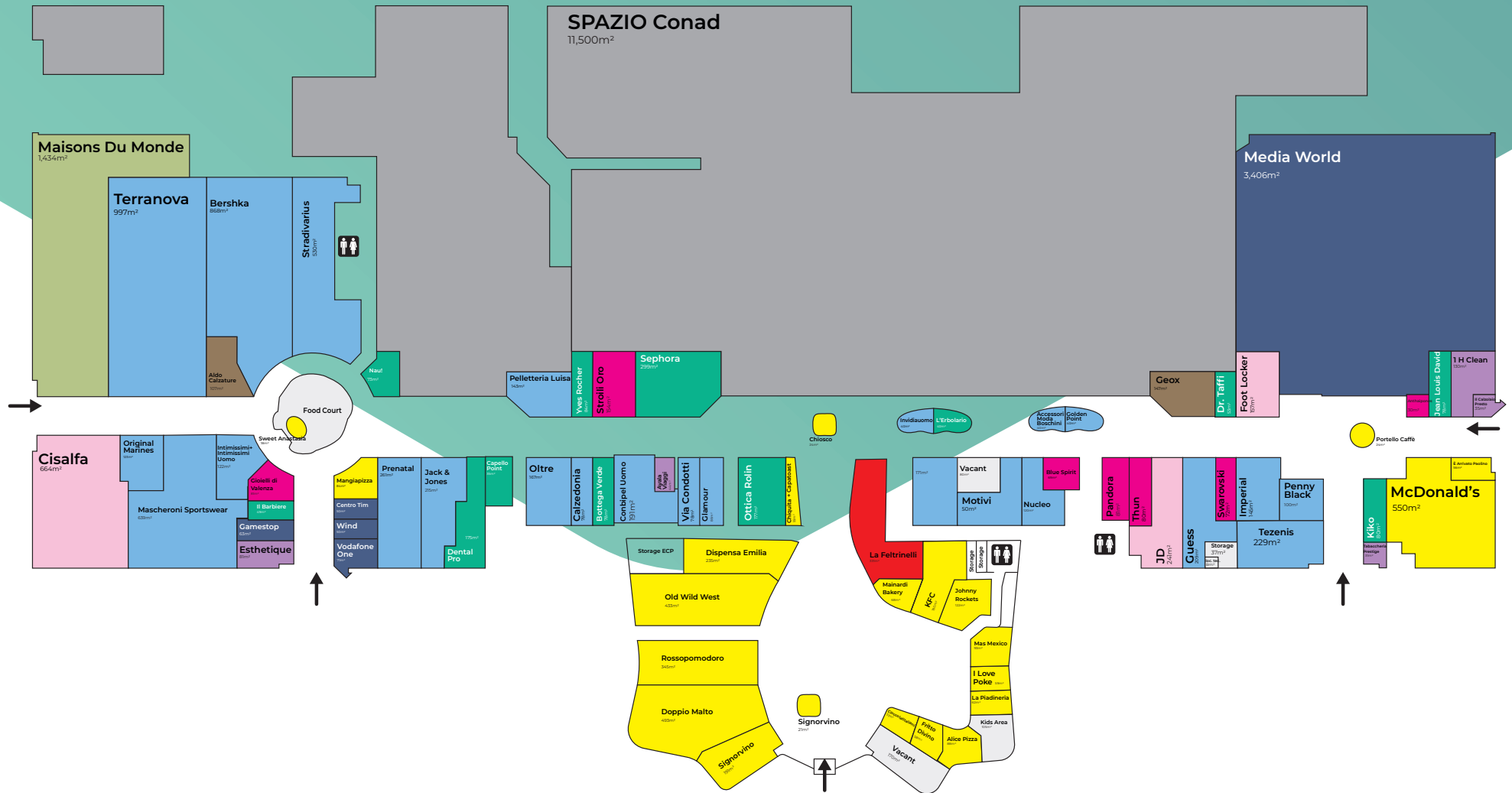

- Fashion
- Shoes
- Health & Beauty
- Gifts & Jewellery
- Books & Toys
- Restaurants
- Services (excluding external units)
- Sport
- Home Goods
- Telecom & Electrical
- Vacant